

USER GUIDE 1: Matrix Easy Fit

MATRIX SHEETS JUST GOT EASIER

Zoned seat/back junction: All sheet sizes are now available with 2ball zones instead of limited 4x4, 2ball groups. The **zone** means quicker shaping to compound curves with asymmetries easily fitted (the cost of zoning is now the same as a standard sheet using 4balls).

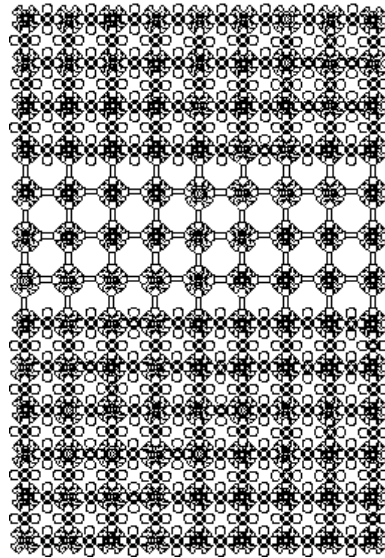

MATRIX INNOVATION

Now and near future: Many of the ideas described here will give innovative options to users. Soon **Surface Modules** will make Matrix 'easy fit'.

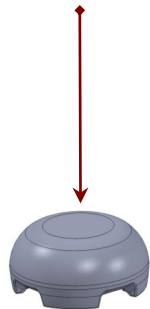

USER GUIDES:

1. Matrix Easy Fit
2. Matrix Backs
3. Matrix Seats
4. Pivot Mounting: Backs + Seats
5. Product Management (x 3)

REMEMBER:

EASY FIT PARTS AND EARLIER MATRIX GENERATIONS ARE NOT INTERCHANGEABLE AND NO ATTEMPT SHOULD BE MADE TO USE THEM TOGETHER.



matrixseating

our products support you

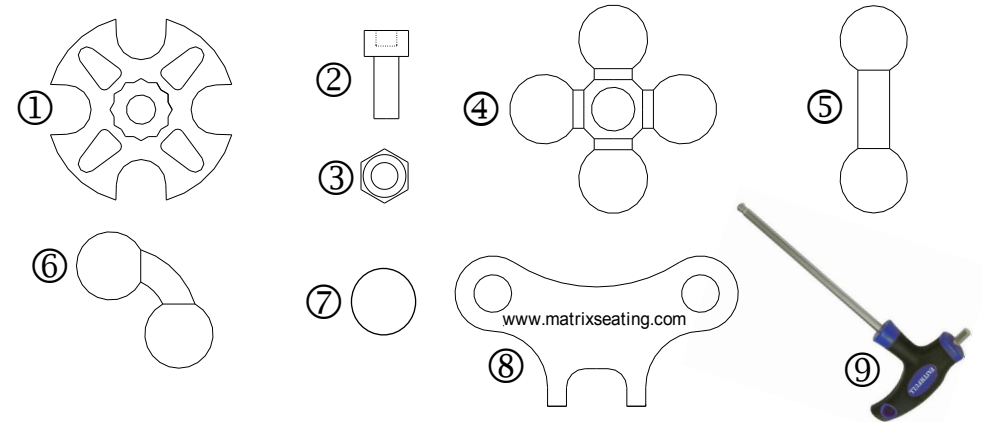

GENERAL DESCRIPTION OF PARTS AND TOOLS:

- ① Clamp half, 2 needed to make a full clamp
- ② M5x12mm socket head screw that uses a 4mm ball nose hex key
- ③ M5 nut (nut in one half clamp, M5x12 screw in the other half clamp)
- ④ 4-ball, 2 options: **Black = standard; Dark Red = flexible**
- ⑤ 2-ball, 2 options: **Black = standard; Dark Red = flexible**
- ⑥ 90° 2-ball, 2 options: **Black = standard; Dark Red = flexible**
- ⑦ Edge ball to complete outer edges of Matrix
- ⑧ Matrix Key for rotation of clamp during live fitting (see bottom of page 2)
- ⑨ 4mm T-handle hex-key, ball nose and square end (Matrix, Pivot, cladding)

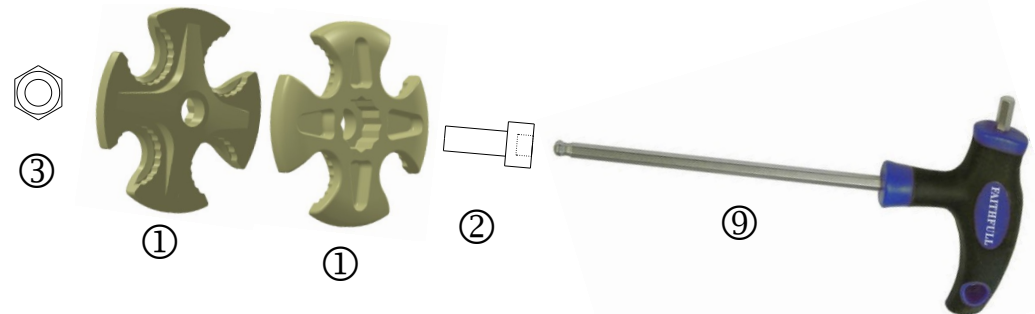

The user of this equipment, including carers and professionals who may adjust and handle it, should study these Instructions. These Instructions contain important information about the use and application of Matrix Easy Fit. Because of the clinical and safety ramifications of misuse, injury to the user or others could result if you are unclear about how it works. Please keep these Instructions to refer to later.

Matrix Seating Limited (MSL) accepts no liability from mis-application of this product.

IMPORTANT: PLEASE NOTE

**EASY FIT PARTS AND EARLIER MATRIX GENERATIONS ARE NOT INTERCHANGEABLE
AND NO ATTEMPT SHOULD BE MADE TO USE THEM TOGETHER.**

STANDARD MATRIX CONFIGURATIONS

- 1 Standard Matrix configuration
- 2 'Close weave' Matrix, stronger than 1 but slightly less 'shapeable'
- 3 'Close weave' using 90° 2balls on outer edge—useful, e.g., around trunk under axilla

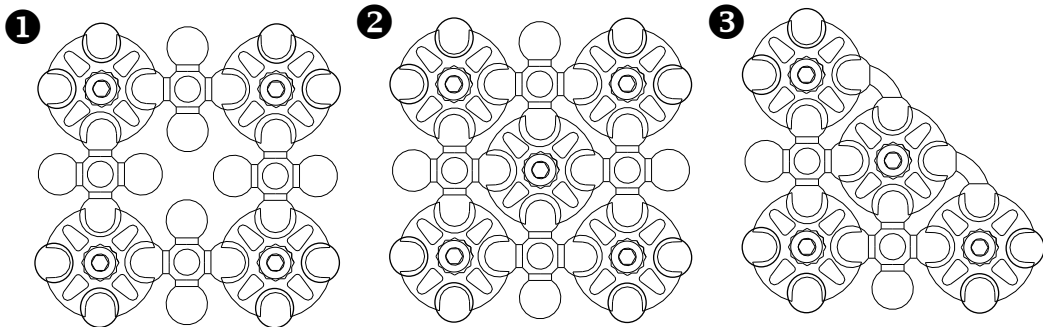

- 4 Using 2balls instead of 4balls as in 1. Rotating the clamp, using the Matrix Key, allows 'tapering' of the Matrix to fit to complex surface anatomy in 3D.

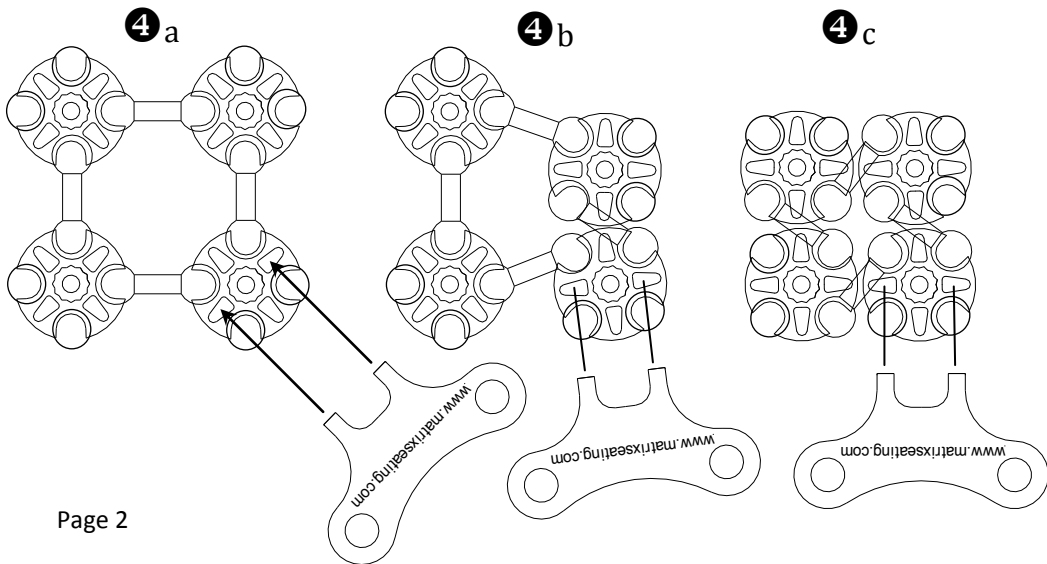

HINTS FOR HANDLING MATRIX

Tightening the hex screw controls Matrix structural strength. When undone the clamp comes apart and the nut off; when completely tightened (when the two clamp halves touch in the middle) the structure is locked in position. So . . .

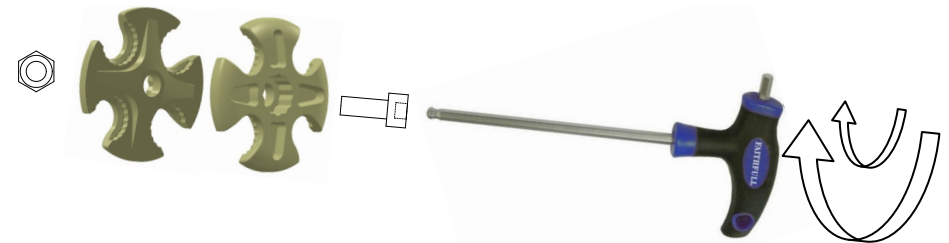

- **Tightened a little**, the structure can be made as stiff as needed, eg., for a live back fitting when Matrix must hold its weight against gravity (plus a bit extra)
- **When fully tightened** (the two clamp halves will touch and the screw will 'bottom') the structure is at maximum strength.



Only **fully tighten** when the final desired shape is obtained. Make this the **last action** after fitting to the client or cast. Never tighten beyond this.

USING FLEXIBLE COMPONENTS

All the main interconnecting parts, **4balls and 2balls**, can now be obtained in a flexible material. These are all **Dark Red** so at a glance they discretely locate the flexible areas within the Matrix structure.



- **Soften the edges:** Using the flexible **Dark Red** parts near the edges can make them more compliant.
- **Within the structure:** Flexible **Dark Red** parts can be used creatively for position, pressure and spasm management, e.g., lateral hinges, soft lumbar shaped areas, softer pommels, etc.

